

baufit[®]



INSTALLATION MANUALS

CASAMENT WINDOWS & DOORS

» HOW TO INSTALLATION?

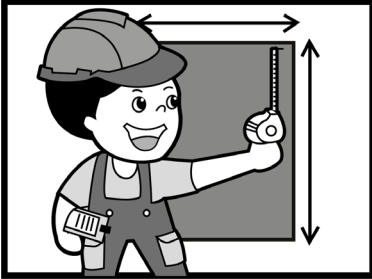

STEP 01

Prepare wall for installation. Size of the wall has to be 5 mm more bigger than frame.

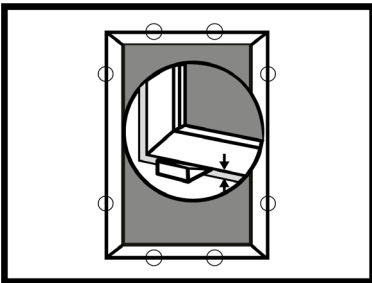

STEP 02

Place the uPVC casement window frame in to the wall. Insert wedges all side (8 point like the photo) to see if window is in correct level placement.

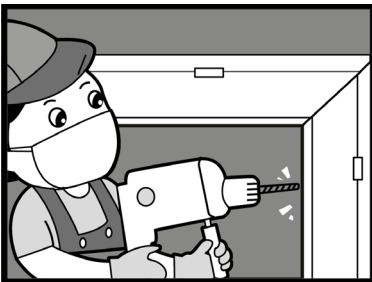

STEP 03

Drill to the edge of frame.

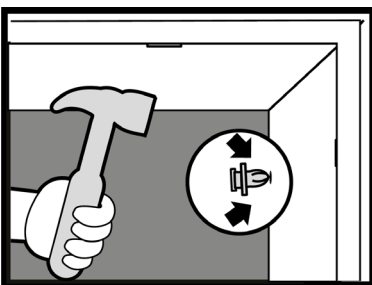

STEP 04

Insert the plastic plug.

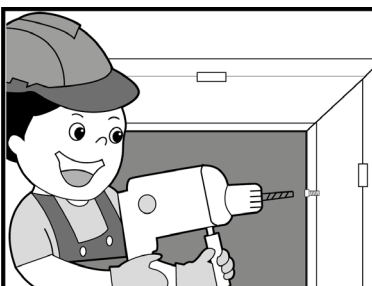

STEP 05

Secure window to wall with screw

» HOW TO INSTALLATION?

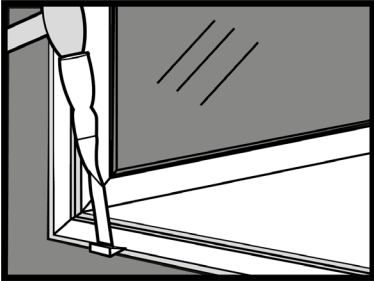

STEP 06

Cut the wedges.

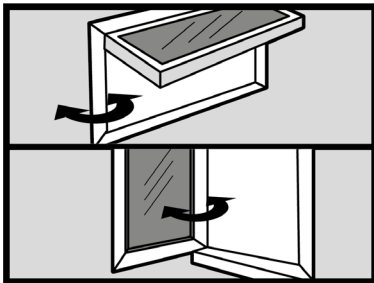

STEP 07

Checking again all part if it can be open and close after installation.



STEP 08

Seal the window with silicone sealant both indoor and outdoor.



STEP 09

Take o the Im sticker, clean the glass and frame.

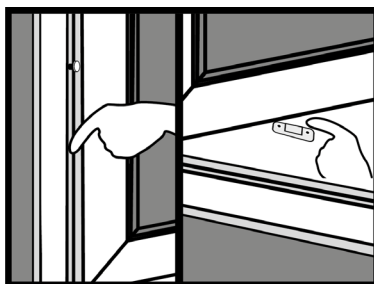

STEP 10

Cover the screw and seal water drain cover to complete installation.

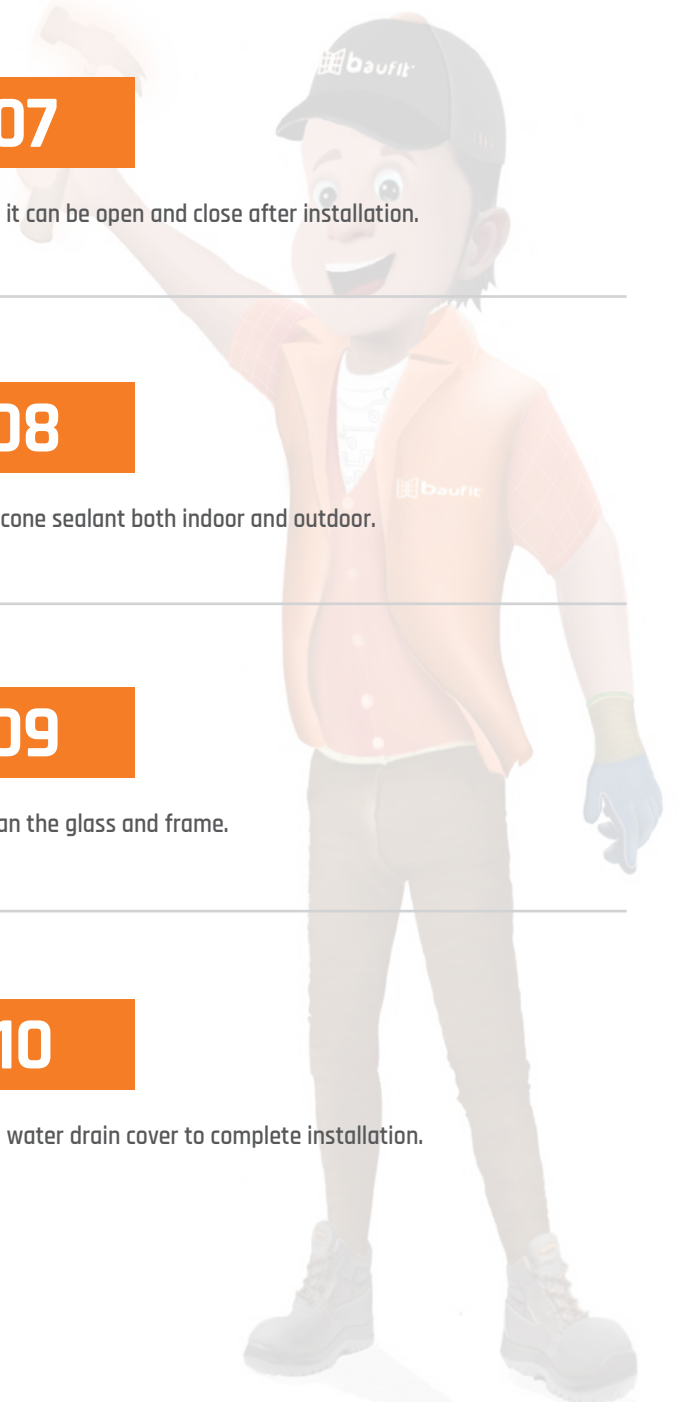

INSTALLATION MANUALS



Alliance Eurasia S.A.S

Address: 41 Avenue Grand Clement Valux-en-Velin 69120
Lyon , France
Tel: +33 750 99 6454
E-Mail: msarikaya@baufit.com

BAUFIT D.O.O

Address: Magistralni put 246, Industrijska zona Maline, 75270, Živinice,
Bosnia/Herzegovina
Tel: +387 35808555
E-Mail: info@baufit.ba

Asia & Middle East

Address: Konak Mah. Lefkose Cad. Baris Sok. Ofis + Plaza No:3 Kat:1 Daire no: 12
PK: 16265 Nilufer/Bursa/Turkey
Tel: +90 224 205 0474
E-Mail: info@baufit.com

Baufit Asia Co. Ltd

Address: 321/1 Phatthanakan Rd, Khwaeng Prawet, Khet Prawet, Krung Thep Maha Nakhon
10250,Thailand
Tel: +66 2 101 2799
E-Mail: support@baufitasia.com | sales@baufitasia.com